



# PRECISION DIGITAL CALIPER MICROTECH



ISO/IES 17025:2006 (cert. № 4K051)

ISO 9001  
BUREAU VERITAS  
Certification



Quality management system  
ISO 9001:2015 (cert. № U228396)





# 1.MODIFICATIONS

Item No	Range	Resolution	Accuracy*	Jaw length	Proof	Guides lubrication	Data output
141082112	0-150	0,005	±0,020	40	IP-54	-	RS-232
141084112	0-150	0,005	±0,020	40	IP-54	+	RS-232
141082212	0-200	0,005	±0,020	50	IP-54	-	RS-232
141084212	0-200	0,005	±0,020	50	IP-54	+	RS-232
141082313	0-300	0,005	±0,030	60	IP-54	-	RS-232
141084313	0-300	0,005	±0,030	60	IP-54	+	RS-232

\*MAX ERROR FOR INTERNAL END DEPTH MEASUREMENTS DIN-862

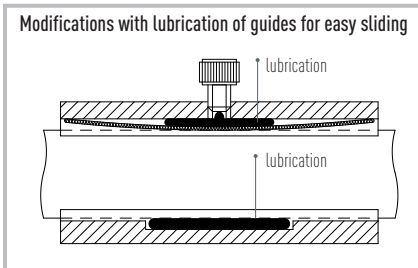

# 2.BUTTON FUNCTIONS

Switch between metric and English measurement systems

Switching on/off



Setting base ZERO point (5 sec switch)

Switching between absolute and relative measurement (display INC) or setting ZERO



## 3. OPERATION INSTRUCTIONS

3.1 Wipe with a clean cloth, soaked in gasoline, measuring surface of the frame and gauge calipers to remove anti-corrosion oil. Then wipe them with a clean dry cloth.

3.2 If necessary, open the battery cover; insert the battery (type CR1632) according to the polarity of the electrodes. Blinking display information or absence suggests replacing battery.

3.3 This caliper has Autoswitch on/ off function:

- move electronic module for switch on caliper
- after 10 minutes without any moving caliper will switch off

3.4 During the measurement, measuring jaws should to sum to the measured object without knocking.

3.5 During the measurement avoid warps of measuring surfaces of the instrument. Measuring surface must be fully in contact with the measurement object.



## WARNING!

**IN THE PROCESS OF WORKING WITH CALIPERS SHOULD BE AVOIDED:**

**Scratches on the measuring surfaces;**

**Measuring the size of object in the process of machining;**

**Shocks or dropping, avoid bending of rod or other surfaces.**





# 4. INSTRUMENT FIGURE

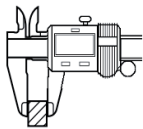
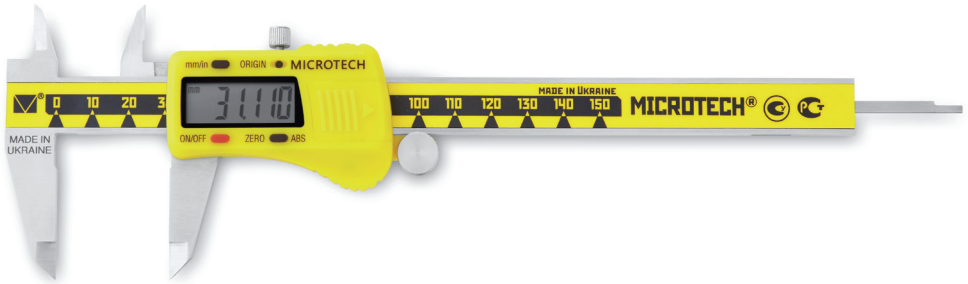

NO

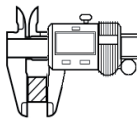

YES



NO



YES

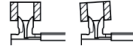

NO



YES

