

COMPUTERIZED FORCE CALIPER

USER MANUAL





Item No	Range		Resolution		Accuracy	External Force	Protection
	mm	inch	mm	inch	μm	N	
141077321	0-300	0-12"	0,005	0.0002	± 20	8	IP54

TECHNICAL DATA

Parameters	
LED display	color 1,54 inch
Resolution	240x240
Indication system	MICS 3.0
Power supply	Rechargeable Li-Pol battery
Battery capacity	450-800 mAh (depends of device)
Charging port	micro-USB
Case material	Aluminium
Buttons	Switch (Multifunctional), Reset
Wireless data transfer	up to 50m on open area

Clean the oil from the measuring surfaces of caliper by cloth.
For recharging caliper (Li-Pol rechargeable battery) connect it with standard USB cable to charger device.

**DO NOT LEAVE UNCHARGED CALIPER FOR A LONG TIME.
THIS MAY RESULT TO INTERNAL BATTERY FAILURE!**

MAIN INFO



MICROTECH

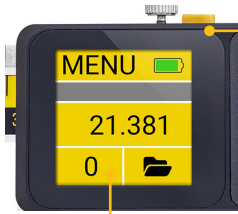

SWITCH ON DEVICE - button push (1 sec)

SWITCH OFF DEVICE - button push (3 sec)/ auto switch off

DATA TRANSFER - programming throw menu

ZERO SETTING - push 5 sec to ZERO setting

CHARGING



BUILT-IN BATTERY - rechargeable Li-Pol battery



For charging connect USB cable

FORCE CONTROL



FORCE control module 8N

For zero setting use Force control module- line inside lens must be came off with outside line.

Press the **ZERO** button on Touchscreen for ZERO position setting.

During a measuring use Force control module to measure with optimal Force

BASE RECONNECTION

Sometimes, when battery was uncharges for a long time - necessary to make reading base reconnection

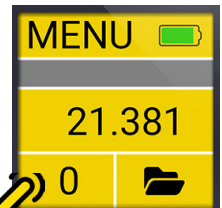

PUSH ZERO button (5sec.) on main screen



Activate WIRELESS data transfer in WIRELESS menu

Switch on Wireless data transmission
Activating multifunctional button to save value to memory or send data by touchscreen or button push

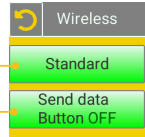

Connect instrument with MICS indication system to Tablet or PC

Send data to Tablet or PC:

- by Touchscreen
- by Multifunctional button push (activated in Wireless menu)
- by Timer (activated in Timer menu)
- from Internal Memory

MEMORY

For save measuring data to internal caliper's memory touch data area on screen or short button push. You can view saved data through menu or send Wireless connection to Windows PC, Android or iOS devices.

Basic STATISTIC functions:

- MAX - maximum saved value
- MIN - minimum saved value
- AVG - average value
- D - variance VAR(x)

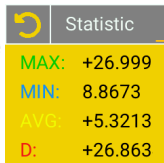

Saved values

Each value can be Deleted or Send to application

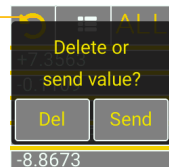

Button ALL select all values
All values can be Deleted or Send to application

MEMORY settings

Memory sub-menu

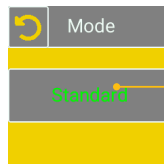

Selecting Standard mode or
No saving data to internal memory



WIRELESS CONNECTION



USB-DONGLE

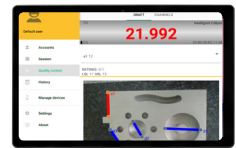
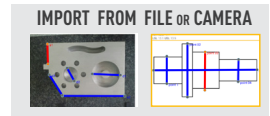

Windows



iOS



ANDROID

DOWNLOAD



DOWNLOAD



DOWNLOAD



SAVING DATA TO XLS. CSV FORMATS



SAVING DATA TO XLS. CSV FORMATS



SAVING DATA TO XLS. CSV FORMATS



TRANSFER DATA TO CAD, SPC OR OTHER SOFTWARE



SAVING GRAPH



SAVING GRAPH



TRANSFER DATA TO EXCEL OR OTHER TABLE EDITORS



VOICE MODE



VOICE MODE

DATA TRANSFER DISTANCE FOR INTELLIGENT INSTRUMENTS

- All MICROTECH Intelligent instruments has internal memory. You can collect data to memory and when it will be necessary transfer all data to the peripheral device with no data losing.
- It's possible transfer data, like in Wireless instruments up to 15 m or up 50 m with external antenna
- USB port can be used to transfer data directly to Windows PC



QUALITY CONTROL RESULTS



MENU NAVIGATION



USE TOUCHSCREEN TO OPERATE MENU

MENU button **MENU** Battery Level

Colour can be changed according function **-0.0000** Actual value

Zero setting **0** Memory

MEMORY WITH STATISTIC

ALL	Statistic
+7.3563	MAX: +26.999
-0.1109	MIN: 8.8673
+1.2293	AVG: +5.3213
+26.9993	D: +26.863
-8.8673	

MENU CONFIGURATION



MAIN MENU



LIMITS
color Go/NoGo

Max/Min

Enable

OK

MAX/MIN
indicating max or min value

Formula

AX+Bx+C

Set Aray

FORMULA MODE
 Ax^2+Bx+C

Timer

+000 sec.

RESET



0.8970

0.8920

OK

RESET

ERROR COMPENSATION
mathematical correction

Temp.comp.

Blank Check
Solid always, Mo

+00.00

TEMPERATURE COMPENSATION
manual correction

Resolution

X.0000

Millimeters

RESOLUTION
selected up to 0.0001mm

Extra

Axis Mode
Normal

CONNECT



Wireless

Standard

Send data

Button OFF

WIRELESS
modes of data transmission

Mode OFF

UART OFF

Keypad On

CONFIRM

USB
USB connection configuration

Device

PIN

RESET

DEVICE SETTING
pin, reset

Display

Angle 180

Sleep 0:05



Mode

Standard

MEMORY SETTING

Link to software

SOFTWARE
link to download app

Calibration

DAY MONTH YEAR

01 01 2020

CHANGE

CALIBRATION DATE

MICROTECH

www.microtech.us

COMP.CALIPER 1

FW: 3.0.5

MAC: 12345



LIMITS GO/NOGO

MENU SETTING

- +000.000 → MAX value
- +000.000 → MIN value
- RANGE → zero values

Colour indication limits

- MAX - NoGo more MAX value
- MIN - NoGo less MIN value
- RANGE - Go between MIN & MAX
- NONE - disactivating mode

MAIN SCREEN INDICATION

MENU		
-10.005		+8.0608
0	mm	0 mm

NoGo **Go**

MAX/MIN

MENU SETTING

- Max/Min
- Enable
- MAX

Indication and saving MAX or MIN values

- ENABLE - activating mode
- MAX - indicating MAX measured value
- MIN - indicating MIN measured value

MAIN SCREEN INDICATION

MENU		MENU	
-2.9184		7.2241	
0	MIN	0	MAX

FORMULA

MENU SETTING

- Formula
- AX+BX+C
- Set Argv
- RESET

FORMULA Ax^2+Bx+C

Formula: $4x^2+Bx+C$

- A +000.000 → Long push digit to select value
- B +001.000
- C +000.000
- RESET → Reset to zero arguments

EXAMPLE OF FORMULA USING

Standard measuring	A=0, B=1, C=0
PRESET 50mm	A=0, B=1, C=50
Value magnification x3	A=0, B=3, C=0
Square value	A=1, B=0, C=0

TIMER

MENU SETTING

- Timer
- +000 sec.
- RESET

Saving data to memory or sending Wireless by Timer

- Select timer period
- Reset to deactivate mode

Confirm reset? Yes No



MATHEMATICAL ERROR COMPENSATION

MENU SETTING Mathematical correction points with big error to normal values

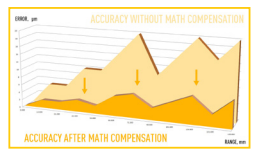
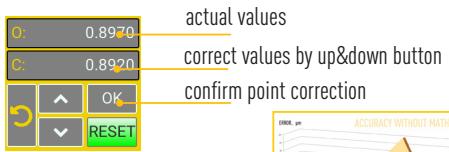

use gauge blocks or measuring machine for points correction

TEMPERATURE COMPENSATION

MENU SETTING Re-calculation detail size to calibration conditions (20°C)

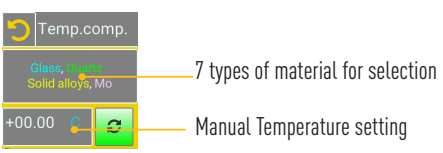

- 7 types of material:
- glass, quartz, solid alloys
 - granite, graphite
 - Fe, Ni, Fe alloys
 - stainless steel
 - cooper, Cu alloys
 - aluminium, al alloys
 - acrylic sheet

RESOLUTION

MENU SETTING



MAIN SCREEN INDICATION

+8.0608

Selecting resolution of value on main screen and memory

EXTRA (Axis mode)

MENU SETTING

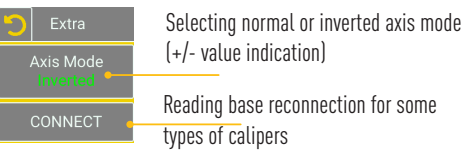



WIRELESS CONNECTION

MENU SETTING

Activating or deactivating wireless data transfer

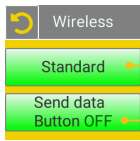

Switch on Wireless data transmission

Activating multifunctional button to save value to memory or send data by touchscreen or button push



USB CONNECTION

MENU SETTING

USB connection mode under construction

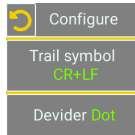
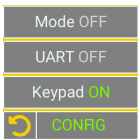

PIN & RESET

MENU SETTING

Activating PIN to device setting

RESET to factory settings

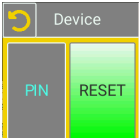

DISPLAY SETTING

MENU SETTING

DISPLAY ROTATION, BRIGHTNESS, SLEEPING MODE

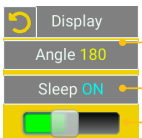

Display rotation 0°, 90°, 180°, 270°

- Sleep OFF (15 s low brightness off, sleep off)
 - Sleep 15s (15 s low brightness on, sleep off)
 - Sleep ON (15 s low brightness on, sleep on)
- Brightness level

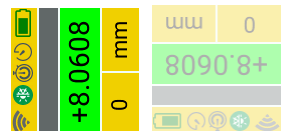

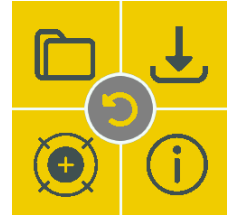

MEMORY SETTINGS

MENU SETTING Activating or disactivating saving values to memory

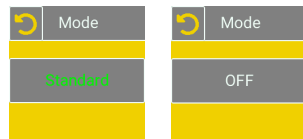

Standard - saving values to memory
OFF - disable saving to memory

↻	☰	ALL
+7.3563		
-0.1109		
+1.2293		
+26.9993		
-8.8673		

LINK TO SOFTWARE

MENU SETTING



QR Link to MICROTECH web site page with MDS Software download
- Android, iOS, Windows versions
- Free and Pro versions
- Manuals

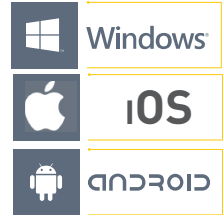

CALIBRATION DATE

MENU SETTING Calibration date info

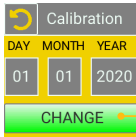

Push for change date info

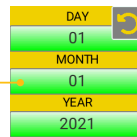

DEVICE INFO

MENU SETTING



Information about device
- device name
- firmware version
- MAC adress for easy connection

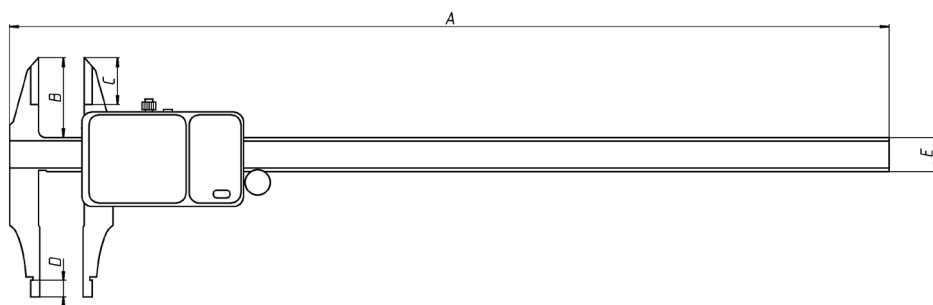

Range	DIMENSIONS				
	A	B	C	D	E
mm	mm	mm	mm	mm	mm
0-300	413	40	24	10	17



MICROTECH



MICROTECH

innovative measuring instruments

61001, Kharkiv, Ukraine, str. Rustaveli, 39

tel.: +38 (057) 739-03-50

www.microtech.ua

tool@microtech.ua

Change without prior notice

Edition: M1030_0520